

PRESS KIT

GARDEN CITY MEGA CITY

RETHINKING CITIES FOR HIGH-DENSITY
AND HIGH-AMENITY LIVING IN THE AGE OF
GLOBAL WARMING

ON VIEW MARCH 23 - SEPTEMBER 4, 2016
OPENING RECEPTION: MARCH 22, 2016

THE SKYSCRAPER MUSEUM
39 BATTERY PLACE
NEW YORK, NY

W O H A



THE SKYSCRAPER MUSEUM

FOR IMMEDIATE RELEASE

GARDEN CITY MEGA CITY: Rethinking Cities for the Age of Global Warming opens at The Skyscraper Museum on March 23rd, 2016

The exhibition showcases WOHA's architecture for high-density, high-amenity living.

NEW YORK, NEW YORK—From commercial mixed-use to hospitality and social housing, Singapore-based WOHA reinterprets the skyscraper as a prototype for hyper-dense, green urban living. Their first major exhibition in the United States, GARDEN CITY MEGA CITY, opens March 23rd, 2016 at The Skyscraper Museum, and unveils twelve of their most recent vertical ecosystems.

Featuring architectural models, videos and renderings, the show contextualizes the firm's towering endeavors as a stunning contribution to skyscraper design and a radical response to the Asian megacity. WOHA's projects—in China, Bangkok, and Singapore, among others—address issues such as rampant population growth, preservation of tropical biodiversity, and the desire for lively community spaces.

With airy pathways functioning like living social networks and porous façades of tropical vegetation, GARDEN CITY MEGA CITY makes the challenges of the emerging metropolis feel less like structural hurdles and more like stimuli for creative solutions. At a time of climbing urbanization rates and alarming climate change, WOHA's future prospects for vertical villages serve as an enlightening template for architects, designers, and engineers, as well as developers and investors—all those concerned with the future of our cities.

An opening reception for GARDEN CITY MEGA CITY will be held Tuesday, March 22nd from 6:00-8:00 pm at The Skyscraper Museum, 39 Battery Place, New York City. Regular museum hours are 12:00-6:00 pm, Wednesday-Sunday. General admission is \$5, \$2.50 for students and seniors.

ABOUT THE SKYSCRAPER MUSEUM

Founded in 1996, The Skyscraper Museum is a private, not-for-profit, educational corporation devoted to the study of high-rise buildings, past, present, and future. Through exhibitions, programs and publications, the museum explores tall buildings as objects of design, products of technology, sites of construction, investments in real estate, and places of work and residence.

FOR INQUIRIES ABOUT
THE EXHIBITION

The Skyscraper Museum
Josh Vogel
josh@skyscraper.org
+1 212 968 1961

FOR INQUIRIES
ABOUT WOHA

WOHA Architects
Serena Khor
pr@woha.net
+65 6423 4555

FOR PRESS INQUIRIES
IN EUROPE + ASIA

PLANE—SITE
Andrés F. Ramirez
andres@plane-site.com
+49 176 3247 4065

FOR PRESS INQUIRIES
IN THE AMERICAS

ABOVE THE FOLD
John Patrick
jp@abovethe-fold.com
+1 313 338 3774

EXHIBITED PROJECTS



Duxton Plain

Singapore, 2001

A thorough exploration into high-density living in a high-rise tropical environment, WOHA's proposal for the Duxton Plain public housing competition conceptualized a new vision for Singaporean public housing. In return for subsidized housing, a higher degree of community exposure—built into the block's typology, external spaces and circulation paths—was proposed to promote social interaction. At city level, a strong image on the skyline of the cluster of towers with hanging gardens was proposed. At the neighborhood level, a strong street edge was created with commercial activities close to the popular Duxton Plain Park.



Oasia Downtown

Singapore, 2011-2016

A verdant tower of green in the heart of Singapore's dense Central Business District, Oasia Downtown is a prototype of land use intensification with a tropical approach. Instead of a fully glazed and air-conditioned building, the tower contains three well-ventilated atria surrounded by L-shaped blocks of hotel rooms and offices. These provide naturally cross ventilated spaces and dynamic internal views. Each elevated ground level is treated as an urban scale veranda, sheltered by the one above. Landscaping forms a major part of the development's material palette, creating an alternative image that is distinct from the surrounding curtain-walled towers of the CBD.



PARKROYAL on Pickering

Singapore, 2007-2013

Based on the concept of a hotel-and-office in-a-garden, PARKROYAL on Pickering investigates the potential of green intensification in a dense metropolis and transforms the abstract building-as-silhouette into one with rich detail and tactility. Its topographic architecture podium is designed as a land form for landscape that extends the green of the adjacent public park vertically into the building as one continuous sweep of urban parkland. Facilitating the public life of the city, the building's porte-cochere opens up as a gateway that physically and visually links Singapore's business and historical districts.



Sky Forest City Tower

Singapore, 2015

In contrast to the typical skyscrapers of Singapore's downtown, the Sky Forest City Tower is a highly dense and vertical mixed use development that reiterates a human scale over the full height of the building. Conceived as a rock with planted waterfall crevices, the podium adopts a horizontal expression with layered strata of programmes, complemented by an office tower with its height accentuated by vertical planter poles. A hawker center within the podium provides a space cooled by cross-ventilation and large ceiling fans, and enclosed by vegetation. Breezes are drawn through the tower, rising through a hollow central core to cool the stack of offices.



Sky Resort Hotel

Singapore, 2015

A new prototype for hospitality high-rise projects, this urban hotel combines ways to intensify land use and integrate tropical thermodynamic approaches. Four distinct strata are designed to provide hotel guests with multiple ground levels of amenities and recreational spaces. All guest rooms are configured in L-shaped blocks that have naturally ventilated corridors, located around three open-sided atria that facilitate cross ventilation, day lighting and internal views. Large living columns of tropical creepers are juxtaposed against the mass of the towers, creating human-scaled spaces that render the urban hotel with a touch of resort.



SkyVille @ Dawson

Singapore, 2007-2015

SkyVille @ Dawson is a public housing project that addresses the themes of community, variety and sustainability. Three 47-storey towers are designed with breezeway atria that are cooled and ventilated by horizontal and vertical breezeways. Every dwelling unit belongs to a 'Sky Village' that comprises 80 homes. A total of 12 villages are stacked in four layers across the 3 inter-connected blocks. To maintain a sense of human scale, every village shares community spaces and a communal terrace. A publicly accessible park on the roof, and extensive public parkland at ground level, further contributes to the high-density high-amenity development.



Stacked Garden Boutique Offices

Singapore, 2015

Maximizing its small site area and building height limit, this tropical high-rise's work spaces are expressed as seven glass volumes with lobbies and terraces. Each stack is comprised by office suites surrounded on three sides by gardens that can be adapted to include a variety of landscape features, informal break out areas and formal event spaces that support a creative working environment. An exoskeletal structural approach results in column-free interiors and integrates environmental filters into the facade in the form of full height trellis and louvers supporting creepers. The tower harvests renewable energy through photovoltaic panels and the use of heat assisted stack turbines.



The Met

Bangkok, Thailand, 2003-2009

Offering a new model for high-density tropical housing in dense Asian cities, The Met is a prototype of a naturally ventilated, perforated, indoor-outdoor, green tower that is a sustainable alternative to sealed, glazed curtain wall buildings in the tropics. Six 69-storey Breezeway Towers are placed on a staggered plan, with horizontal and vertical breezeways facilitating cross ventilation and daylight penetration through the blocks. All apartments are designed as one-unit-thick, making tropical living without air-conditioning possible.



Tropical Urban Business Park

Penang, Malaysia, 2014

Located within the land scarce and highly built-up island of Penang, the Tropical Urban Business Park is an extremely high density mixed use development that differentiates itself through its vertical greenery and public spaces. A massive Sky Park shelters a mix of apartments, offices, recreation areas and shopping malls. Every component is visually and socially interconnected, so that the entire mini-city complex possesses a neighbourhood-style vibrancy.



Vanke Cloud City

Shenzhen, China, 2014

Inspired by the natural mountain parks in Shenzhen, Vanke Cloud City is designed with twelve "floating hills" that connect three office towers configured around a centralized core. Accommodating amenities for workers, the hills serve as the refuge and lift transfer floors of the tower. Designed as large internal atria with pockets of cascading sky gardens and planted waterfall valleys, the hills function as naturally ventilated outdoor spaces that are shielded from the wind and rain. This opens up the common lift lobby areas to daylight, greenery and fresh air, creating a comfortable micro climate and biophilic working environment within the tropical high-rise.

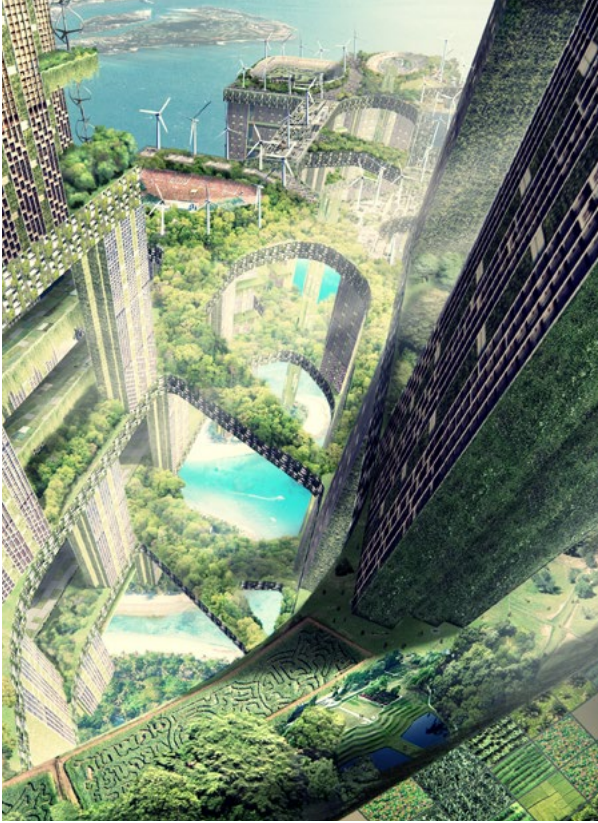

Permeable Lattice City

Singapore, 2011

For the Vertical Cities Asia program organized by the National University of Singapore (NUS), WOHA envisioned a vertical city with a modular arrangement in a staggered alignment to create a high degree of perforation and porosity resulting in cross-ventilated breezeways at city scale. These "City Columns" free up the real ground level for nature reserves and heavy industries, and are held together structurally by a network of "City Conduits" that serve as elevated ground levels. They are connected by "City Community Spaces" and multi-cabin lifts and circulation systems that map out a fully pedestrianized city, encouraging a highly sustainable and livable city.

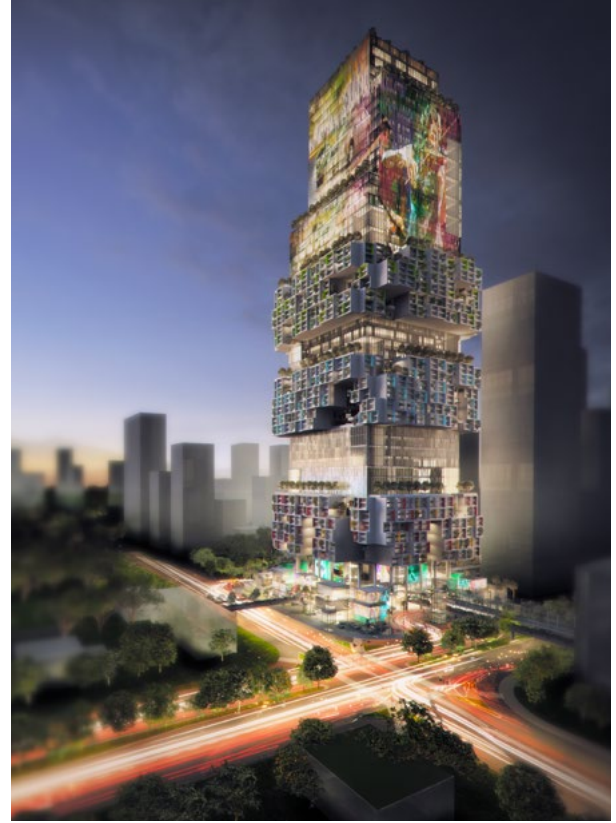

Vertical Stacked City

Shenzhen, China, 2014

As the new city of Shenzhen in southern China has no historic urban grain or pattern of settlement, the Vertical Stacked City sets out to create a sense of sociable street-life by stacking fine-scaled community clusters of Small and Medium Enterprises (SMEs) between urban-scaled stacks of corporate offices at Multiple Ground Levels. Instead of a typical enclosed shopping mall, the Vertical Stacked City rises above a collection of individual shops within a ground level urban plaza, sheltered by the tower above. Comprising a mixture of home offices, small offices, and cafes, these naturally ventilated villages aim to recreate the street-life of the crowded precincts of traditional Chinese cities.

ABOUT WOHA

In 1994, architects Wong Mun Summ and Richard Hassell founded Singapore-based WOHA. As one of Southeast Asia's preeminent architectural offices, WOHA integrates environmental principles at every stage of the design process. Their strategies champion biodiversity, sustainability, and the local vernacular to design responsive building solutions for the city of tomorrow. The firm's awareness of context and tradition is intertwined with an ongoing exploration of contemporary architectural questions, uniquely fusing practicality and invention.

WOHA's architectural repertoire—throughout Southeast Asia, China, and Australia—ranges from residential towers and hotels to transportation hubs and public institutions. Their designs reconfigure the elements of a building, breathing smart design into the dense landscape of the megacity. WOHA's blueprint for sustainable development imagines a biophilic future where towering structures evolve in harmony with native ecosystems and urban communities.

Underscoring WOHA's contributions to the advancement of architecture, the practice has received numerous international awards, including the International Highrise Award (2010), the prestigious Aga Khan Award for Architecture (2007), the renowned RIBA Lubetkin Prize (2011), and most recently, the Urban Habitat Award (2015). The firm's most acclaimed projects have been featured in many international publications, including *Tropical Energy Efficient Systems* (2015), *Best Tall Buildings* (2015), *Green Walls in High Rise Buildings* (2014), and *The Phaidon Atlas of 21st Century World Architecture* (2011). In 2011, a traveling exhibition devoted exclusively to their work opened at the Deutsches Architekturmuseum in Germany. *Garden City Mega City* (2016) follows the publication of four substantial monographs—*WOHA: Selected Projects Vol. 1* (2011) and *Vol. 2* (2014), *WOHA: Breathing Architecture* (2011), and *WOHA: The Architecture of WOHA* (2009).

Blending practice and pedagogy, Hassell and Wong also teach at the National University of Singapore and have lectured widely at universities around the world such as the Harvard University Graduate School of Design, the University of Hong Kong and the University of Western Australia.

FOUNDING DIRECTORS



Wong Mun Summ is Founding Director of Singapore-based WOHA, one of Southeast Asia's best known and most awarded architectural practices. Wong graduated with Honors from the National University of Singapore in 1989. He has been heavily involved in urban and civic affairs in his native Singapore, serving as a board member of the Urban Redevelopment Authority (URA) from 1999 to 2005, as well as part of the Board of Architects' Design Panel. He has also contributed to the International Design Consultancy for the Waterfront at the Downtown at Marina Bay, and served as a member of URA design advisory panels for major developments throughout Singapore.

Weaving practice and pedagogy, he has mentored students under the National University of Singapore's Embedded Studio in Practice program and, together with Richard Hassell, has served as Studio Master for the University's Integrated Sustainable Design Masterclass since 2011. In 2015, he was appointed Professor in Practice at the National University of Singapore.



Richard Hassell is Founding Director of WOHA Architects, formed in partnership with Wong Mun Summ in 1994. He graduated from the University of Western Australia in 1989 and was awarded a Master of Architecture degree from the RMIT University, Melbourne in 2002. Both a practicing architect and educator, Hassell has lectured widely at various universities around the world, and is currently an Adjunct Professor at the University of Western Australia. Together with Wong Mun Summ, he has been Studio Master for the National University of Singapore's Integrated Sustainable Design Masterclass since 2011.

Hassell is a member of Singapore's Urban Redevelopment Authority's (URA) Design Advisory Committee and has been a member of the Housing and Development Board (HDB) Architectural Design Panel. He has served as a board member of the Building and Construction Authority of Singapore, as well as committees for the URA and the DesignSingapore Council.

PROJECTS CHRONOLOGY*

1995

House at Meyer Road, Singapore
Conservation Shophouse at Emerald Hill Road, Singapore
House at Merryn Road, Singapore

1996

Semi-Detached Houses at Linden Drive, Singapore

1999

Three Houses at Victoria Park Road, Singapore
Church of St Mary of the Angels, Singapore
House at Maple Avenue, Singapore
House at Hua Guan Avenue, Singapore

2000

1 Moulmein Rise, Singapore
Three Houses at Berrima Road, Singapore
Singapore Management University, Singapore
Stadium MRT Station, Singapore
Bras Basah MRT Station, Singapore

2001

Conservation Shophouse at Telok Ayer Street, Singapore
House at Rochalie Drive, Singapore
Odeon Towers Extension, Singapore
Duxton Plain Public Housing Competition, Singapore
Tan Quee Lan Suites, Singapore

2002

Glistead Brooks, Singapore

2003

The Met, Bangkok, Thailand
Newton Suites, Singapore
Alila Villas Uluwatu, Bali, Indonesia

2004

NOMU, Singapore
Wilkie Edge, Singapore
The Pano, Bangkok, Thailand

2005

The Hyde, Sydney, Australia
UNSW Asia Competition, Singapore (unbuilt)
Hansar, Bangkok, Thailand
School of the Arts, Singapore
Iluma, Singapore
Crowne Plaza Hotel, Changi Airport, Singapore
Genexis Theatre, Singapore

2006

Goodwood Residence, Singapore
Conservation Shophouse at Cairnhill Road, Singapore
InterContinental Sanya Resort, Hainan, China

2007

SkyVille @ Dawson, Singapore
PARKROYAL on Pickering, Singapore

2008

Space Asia Hub, Singapore
CapitaMall Tianfu, Chengdu, China
School of Science and Technology Competition, Singapore

2009

Design 2050 Studios, Singapore (unbuilt)
48 North Canal Road, Singapore

2010

Ogilvy & Mather Office, Singapore
Capitol Theatre Competition, Singapore (unbuilt)
Singapore University of Technology & Design Competition, Singapore (unbuilt)
32 Carpenter Street, Singapore
New Cuffe Parade, Wadala, Mumbai (in progress)
Huaku Sky Garden, Taipei, Taiwan (in progress)
Residential Development at Ardmore Park, Singapore (unbuilt)

2011

Oasia Downtown, Singapore
Mixed Use Development at Ophir Road, Singapore (unbuilt)
Community Town Hub, Singapore (unbuilt)
Permeable Lattice City, Singapore (unbuilt)

2012

BRAC University, Dhaka, Bangladesh (in progress)
Henninger Turm Competition, Frankfurt, Germany (unbuilt)
The Grove, Guangzhou, China
Alila Villas Uluwatu Suites, Bali, Indonesia (in progress)
Neihu Office Tower, Taipei, Taiwan (in progress)
The Park, Mumbai, India (in progress)

2013

Kampung Admiralty, Singapore (in progress)
Academy of Creative Industries and Performing Arts, Hobart, Australia (in progress)
Community Park Station Competition, Singapore (unbuilt)
NUS-SDE Competition, Singapore (unbuilt)
Enabling Village, Singapore
Sky Green, Taichung, Taiwan (in progress)
Mixed Use Development at Senopati, Indonesia

2014

Integrated New Town Masterplan, Jakarta, Indonesia
Singapore Institute of Technology Masterplan, Singapore (in progress)
Tropical Urban Business Park, Penang, Malaysia (unbuilt)
443 Queen Street, Brisbane, Australia (in progress)
Vertical Stacked City, Shenzhen, China (unbuilt)
Vanke Cloud City, Shenzhen, China (in progress)

2015

Sky Forest City Tower, Singapore (unbuilt)
Mandala Park, Jakarta, Indonesia (in progress)
Sky Resort Hotel, Singapore (in progress)
Stacked Garden Boutique Offices, Singapore (in progress)

* Listed by project inception year.

MOST PROMINENT AWARDS

2015

WAN Asia Award (Residential)

Goodwood Residence, Singapore

Awarded by World Architecture News.com

Urban Habitat Award

PARKROYAL on Pickering, Singapore

Awarded by Council of Tall Buildings and Urban Habitat, Chicago, Illinois

2014

Award for International Architecture

PARKROYAL on Pickering, Singapore

Awarded by Australian Institute of Architects

Green Good Design Award

PARKROYAL on Pickering, Singapore

Awarded by The Chicago Athenaeum and The European Centre for Architecture Art Design and Urban Studies

Building of the Year Award

48 North Canal Road, Singapore

Awarded by ArchDaily

2013

INSIDE Festival

PARKROYAL on Pickering, Singapore

Awarded by INSIDE Festival

WAN Hotel of the Year Award

PARKROYAL on Pickering, Singapore

Awarded by World Architecture News.com

2012

Green Good Design Award

The Hansar Bangkok, Thailand

Awarded by The Chicago Athenaeum and The European Centre for Architecture Art Design and Urban Studies

2011

RIBA Lubetkin Prize

The Met, Bangkok, Thailand

Awarded by Royal Institute of British Architects

The Jørn Utzon Award for International Architecture

School of the Arts, Singapore

Awarded by Australian Institute of Architects

RIBA International Award

Alila Villas Uluwatu, Bali, Indonesia

Awarded by Royal Institute of British Architects

RIBA International Award

School of the Arts, Singapore

Awarded by Royal Institute of British Architects

2010

World Architecture Festival

World Holiday Building of the Year

under the Holiday category, awarded by World Architecture Festival

Alila Villas Uluwatu, Bali, Indonesia

World Architecture Festival

World Learning Building of the Year

under the Learning category, awarded by World Architecture Festival

School of the Arts, Singapore

RIBA International Award

awarded by Royal Institute of British Architects

Bras Basah MRT Station, Singapore

RIBA International Award

awarded by Royal Institute of British Architects

The Met, Bangkok, Thailand

The Jørn Utzon Award for International Architecture

awarded by Australian Institute of Architects

The Met, Bangkok, Thailand

The International Highrise Award

awarded by City of Frankfurt, Deutsches Architekturmuseum and DekaBank

The Met, Bangkok, Thailand

2009

World Architecture Festival

World Transport Building of the Year

under the Transport category, awarded by World Architecture Festival

Bras Basah MRT Station, Singapore

World Architecture Festival

World Housing Development of the Year

under the Housing category, awarded by World Architecture Festival

The Met, Bangkok, Thailand

2007

Aga Khan Award for Architecture

awarded by Aga Khan Trust for Culture

No. 1 Moulmein Rise, Singapore

PUBLICATIONS



Bingham-Hall, Patrick.
GARDEN CITY MEGA CITY: Rethinking Cities for the Age of Global Warming. London: Pesaro Publishing, 2016.



Bingham-Hall, Patrick.
WOHA: Selected Projects, Vol. 2. London: Pesaro Publishing, 2014.



Busenkell, Michaela and Schmal, Peter. *WOHA: Breathing Architecture*. London: Prestel and DAM, 2011.



Bingham-Hall, Patrick.
WOHA: Selected Projects, Vol. 1. London: Pesaro Publishing, 2011.

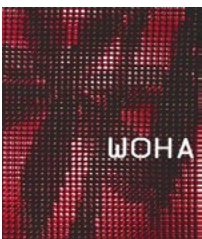

Bingham-Hall, Patrick.
WOHA: The Architecture of WOHA. London: Pesaro Publishing, 2009.

SELECTED EXHIBITIONS



GARDEN CITY MEGA CITY
The Skyscraper Museum, 2016
New York, NY



Fragments of an Urban Future
Palazzo Bembo, 2016 (upcoming)
Venice, Italy



Breathing Architecture
Deutsches Architekturmuseum, 2011
Frankfurt, Germany



More on Less
Aedes Gallery, 2006
Berlin, Germany

RECENT LECTURES AND CONFERENCES

Architecture Asia Pacific Symposium

Brisbane, Australia, March 2016

Sri Lanka Institute of Architects, 33rd National Conference on Architecture

Colombo, Sri Lanka, February 2016

Hong Kong Institute of Architects

Hong Kong, January 2016

University of Hong Kong Lecture Series

Hong Kong, January 2016

Chinese University of Hong Kong Lecture Series

Hong Kong, January 2016

Council on Tall Buildings and Urban Habitat (CTBUH) Annual Awards Symposium

Chicago, IL, USA, November 2015

Harvard University Graduate School of Design Lecture Series

Cambridge, MA, USA, November 2015

“Design For City” International Architectural Summit Forum

Beijing, China, September 2015

4th International Architectural Education Summit (IAES)

Singapore, September 2015

Beijing University of Civil Engineering and Architecture

Beijing, China, July 2015

Beijing China Design Group (CDG)

Beijing, China, July 2015

Shenzhen University

Shenzhen, China, July 2015

South East Asia Pacific Cities Summit and Mayor's Forum

Brisbane, Australia, July 2015

Brisbane Development Association Talk: “Exploring Subtropical Living and Design”

Brisbane, Australia, April 2015

TEDx Talk: “Twisted”

Hong Kong, February 2015